

*Gainsborough*



G+ ACCESS SYSTEM

---

THE EASIER  
WAY TO  
ACCESS  
YOUR HOME



GWA  
Smarter Solutions

---



# MAKE COMING HOME EVEN MORE OF A PLEASURE

For over forty years, we've created high quality door hardware smart in both form and function.

Harnessing the most modern technology, now you can do more than just enter with style. G+ makes it simple to access your home in new ways, adding more convenience, security and style to how you live.

# WHAT IS G+?

We understand you're busy and may have your hands full in more ways than one. The G+ Access System lets you enter your home quickly and securely with the click of a button. But that's just the beginning.

Depending on how you live, the G+ Access System can be customised to suit your home. Entry points such as your front gate, front door, back door, garage door and more, can all be operated from one G+ Key - a discrete, stylish remote available in two designs.

As a starting point, the G+ Essentials Kit allows you to set up remote control access to your front/back home door. By installing G+ Smart Boxes, you can then connect other home devices, such as alarms or external lights, to your G+ Key.

This means you can now open your garage door, turn on your outside light, turn off your security alarm and unlock your front door, all from one G+ Key.

G+ goes beyond customised keyless entry to your home. Once inside, G+ Video Entry lets you see visitors before letting them in with touch screen technology to lock and unlock your door.

If you already have home automation, our G+ Home Hub is designed to work with your existing system. Control entry points, alarms, lighting and more, depending on your existing system's features.

G+. Smart. Simple.

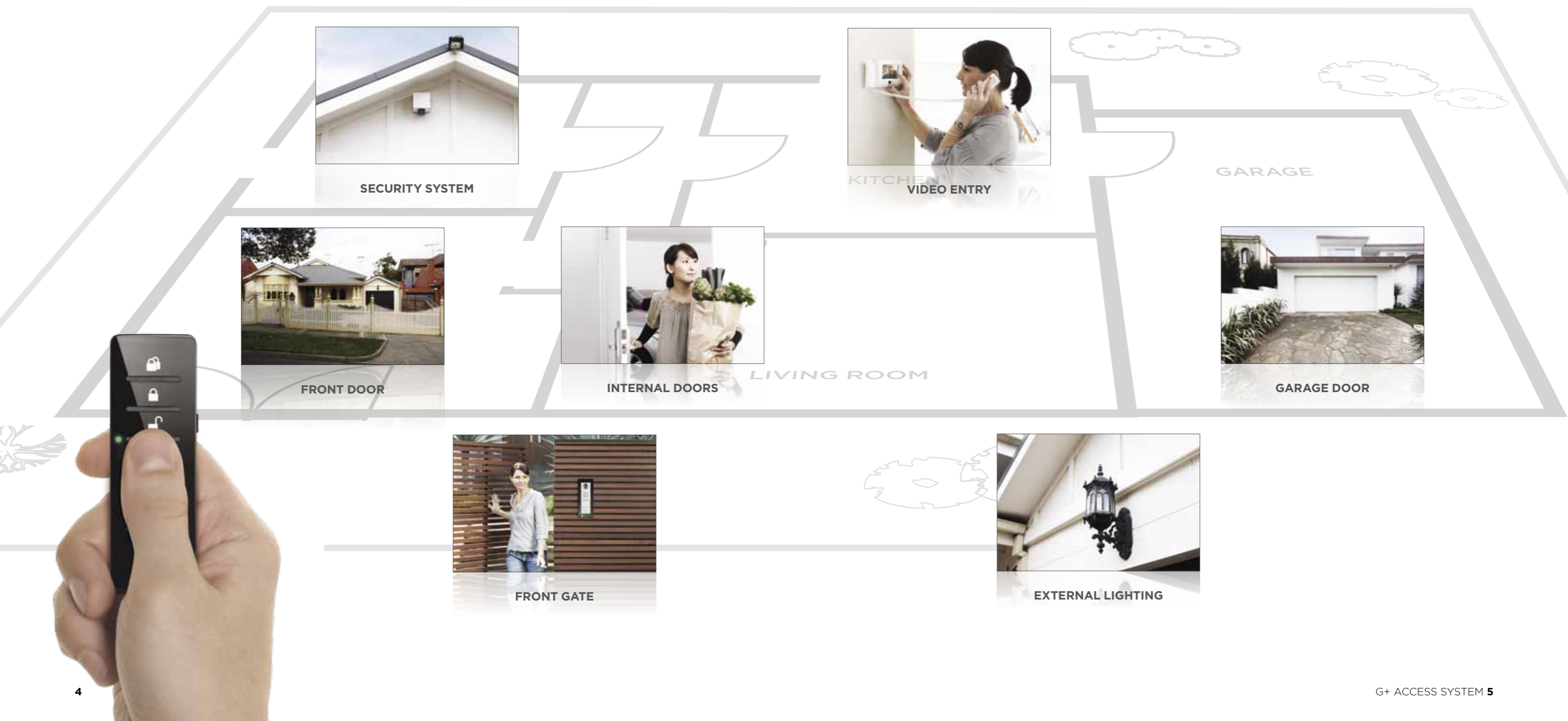

# HOW G+ WORKS



The building blocks of the G+ Access System are our patented G+ Smart Boxes.

## SMART THINKING

More than keyless entry to your home, placing G+ Smart Boxes discreetly near security and access devices in your home lets you control these additional devices via your G+ Key.

Whatever your style of home and however you like to live in it, G+ Technology can change as your life does.

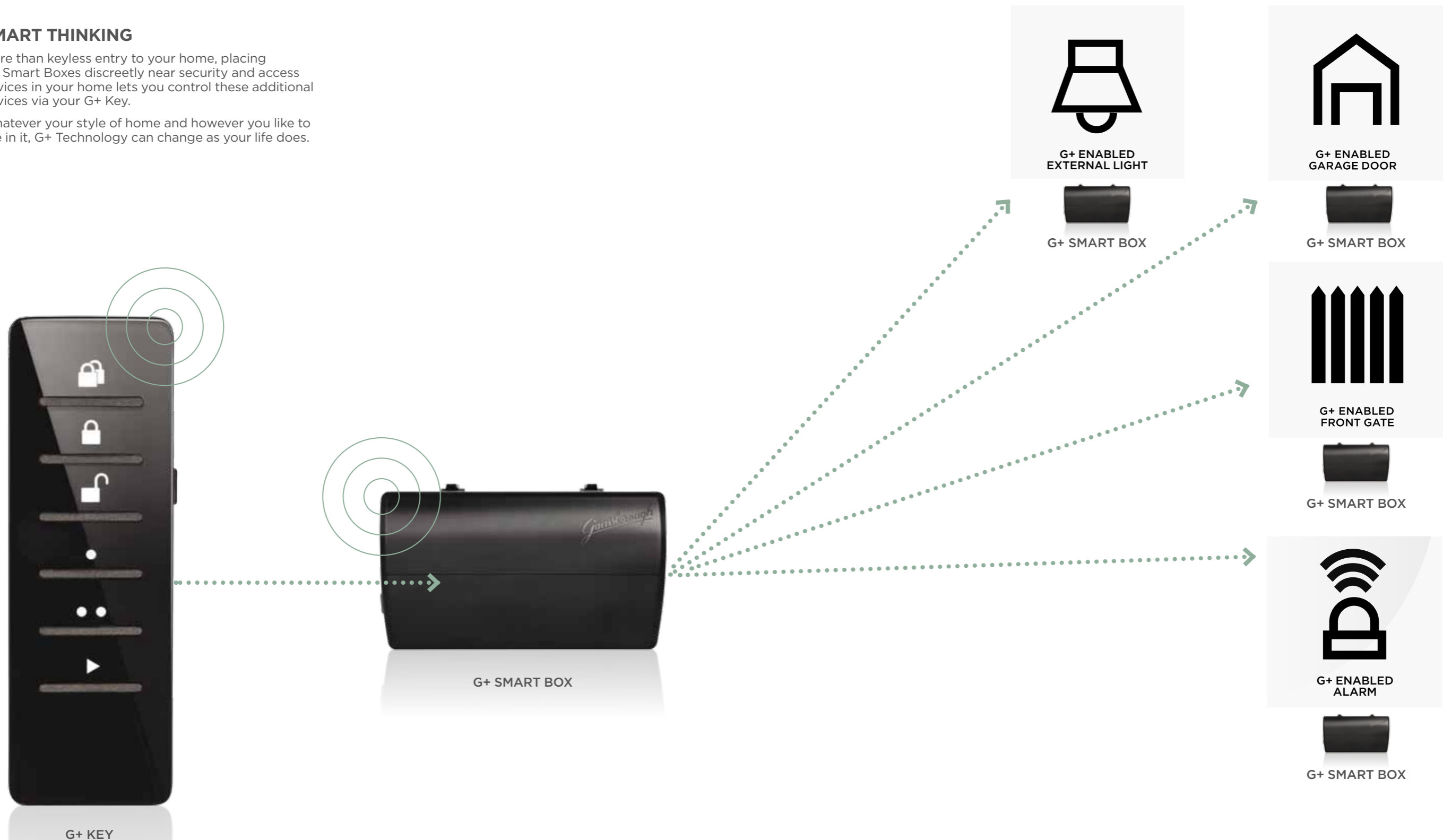

# THE G+ ESSENTIALS

The G+ Key offers you three convenient lock modes depending on the level of security you need.

## GETTING STARTED

At its simplest, the G+ Essentials Kit offers remote access to your front door. Simply click your G+ Key to choose from three convenient lock modes - deadlock, privacy and passage - depending on the level of security you want.

Your smart G+ Key comes with easy-to-find, soft-touch buttons and lights to indicate when your front door is locked or unlocked.



Creating the G+ Access System

G+ ESSENTIALS

# ADD G+ SMART BOXES

G+ Smart Boxes can be installed in relevant areas in your home.

## G+ SMART BOXES

To link garage doors, gates, security lights or other security and access devices to your G+ Key, G+ Smart Boxes can be installed in relevant areas in your home. You can sync your G+ Key to up to ten G+ Smart Boxes.



Creating the G+ Access System

G+ ESSENTIALS

+

G+ SMART BOX

# ADD G+ VIDEO ENTRY

## VISIBLY MORE SECURE

G+ Video Entry adds a new level of security and convenience to your home.

Available in two models, Premium and Basic, the G+ Video Entry Kit lets you see visitors in the security of your own home before letting them in. When you're ready, you can unlock or lock your door from your G+ Video Entry Panel with peace of mind. The G+ Video Entry Kit also allows you to control other G+ Enabled Devices from your G+ Video Entry Panel for further convenience.



G+ Video Entry adds a new level of security and convenience to your home.



# ADD G+ HOME HUB

Operate your G+ Access System through your existing home automation unit with the addition of a G+ Home Hub.

## YOUR HOME AT YOUR FINGERTIPS

If you already have a home automation system, you can operate your G+ Access System through your existing unit with the addition of a G+ Home Hub. Once your G+ Home Hub is installed, most G+ Enabled Technology can be controlled via your home automation panel.



Enjoy the freedom of controlling your front door lock from your existing home automation system.



---

# DESIGNING YOUR G+ SYSTEM

Every part of the G+ Access System is designed to link effortlessly with other G+ Devices. This means you can continue to expand and customise your system in the future.





# DESIGNING YOUR G+ ACCESS SYSTEM

Choose your G+ Access System in 6 easy steps.

## > STEP 1 CHOOSE YOUR SYSTEM

### ELECTRIC SYSTEM

Access your home faster and easier with the Electric G+ Lockset. Choose from four lever styles, each with three different modes: deadlock, privacy and passage. For additional security, locksets indicate when they are locked up or unlocked and come with battery back-up.



### BATTERY SYSTEM

G+ Locksets are also available in a Battery Version. Choose from the same lever designs as the Electric Range, the Battery Version will also work with any G+ Key, is easy to install and runs on four AAA batteries.

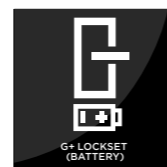

## > STEP 2 CHOOSE YOUR LOCKSET AND LEVER DESIGN

### EXTERNAL VIEW LOCKSETS



**VOLT ANGULAR**  
Shown in satin chrome

### INTERNAL VIEW LOCKSETS



**VOLT ANGULAR**  
Shown in satin chrome



**VOLT FOLD**  
Shown in bright chrome



**VOLT TILT**  
Shown in fusion



**VOLT VERGE**  
Shown in bright gold

### EXTERNAL VIEW LOCKSETS



**APEX VERGE**  
Shown in bright gold

### INTERNAL VIEW LOCKSETS



**APEX ANGULAR**  
Shown in satin chrome



**APEX FOLD**  
Shown in bright chrome



**APEX TILT**  
Shown in fusion



**APEX VERGE**  
Shown in bright gold



### MECHANICAL DOOR LOCKSET

Our range also includes mechanical lockset designs to match the G+ Access System, which means you can create a co-ordinated look and feel throughout the house.

## > STEP 3 CHOOSE YOUR REMOTE

### G+ KEY PREMIUM

Enjoy easier, electronic access to your home with a single G+ Key. Your Premium G+ Key indicates whether your door is locked or unlocked and the key itself can be locked to avoid accidental use.



### G+ KEY BASIC

We also offer entry control via a Basic G+ Key. Enjoy the same electronic access without the indication as to whether your door is locked or unlocked.



# SMART ADDITIONS

## > STEP 4 CHOOSE THE NUMBER OF SMART BOXES YOU REQUIRE

### G+ SMART BOX

G+ Smart Boxes link other electric devices in your home to your G+ Access System. Control garage doors, gates, security lights, alarms and other security and access devices, all from a single G+ Key. Connect up to 10 G+ Smart Boxes to one G+ Key.

**Note:** One G+ Smart Box is required for each electric device you want to control.



## > STEP 5 CHOOSE YOUR HOME HUB

### G+ HOME HUB

The G+ Home Hub connects your G+ Devices to an existing home automation system. Operate most of your G+ Enabled Devices, such as your front door, from your home automation panel.

**Note:** One G+ Home Hub will link either one G+ Lockset or three G+ Smart Boxes to your home automation system. Multiple G+ Home Hubs may be required.



## > STEP 6 CHOOSE YOUR VIDEO ENTRY

### G+ VIDEO ENTRY KIT BASIC

The Basic G+ Video Entry Kit comes with an internal colour screen and push button access. It also includes an integrated intercom which allows you to expand to additional receivers if required. The system fits discretely into the home with the option to either mount or recess into your wall.



### G+ VIDEO ENTRY KIT PREMIUM

The Premium G+ Video Entry Kit is designed with the same features as the Basic plus additional elements for added security. Screen your visitors and control your home through touchscreen technology. The addition of a receiver allows video voice messaging – just in case you're not available to take the call.



Disclaimer: G+ Video Entry models may vary from those images shown

---

# YOUR G+ ENABLED HOME

As the G+ Access System can be tailored to suit any home, it's time to think about what solution is best for you. The following pages are designed to work as a guide in assisting you with how to set up your G+ Enabled Home.



# TYPICAL HOUSE PLAN

The first step is to consider your floor plan and the entry points that would benefit from the G+ Access System.

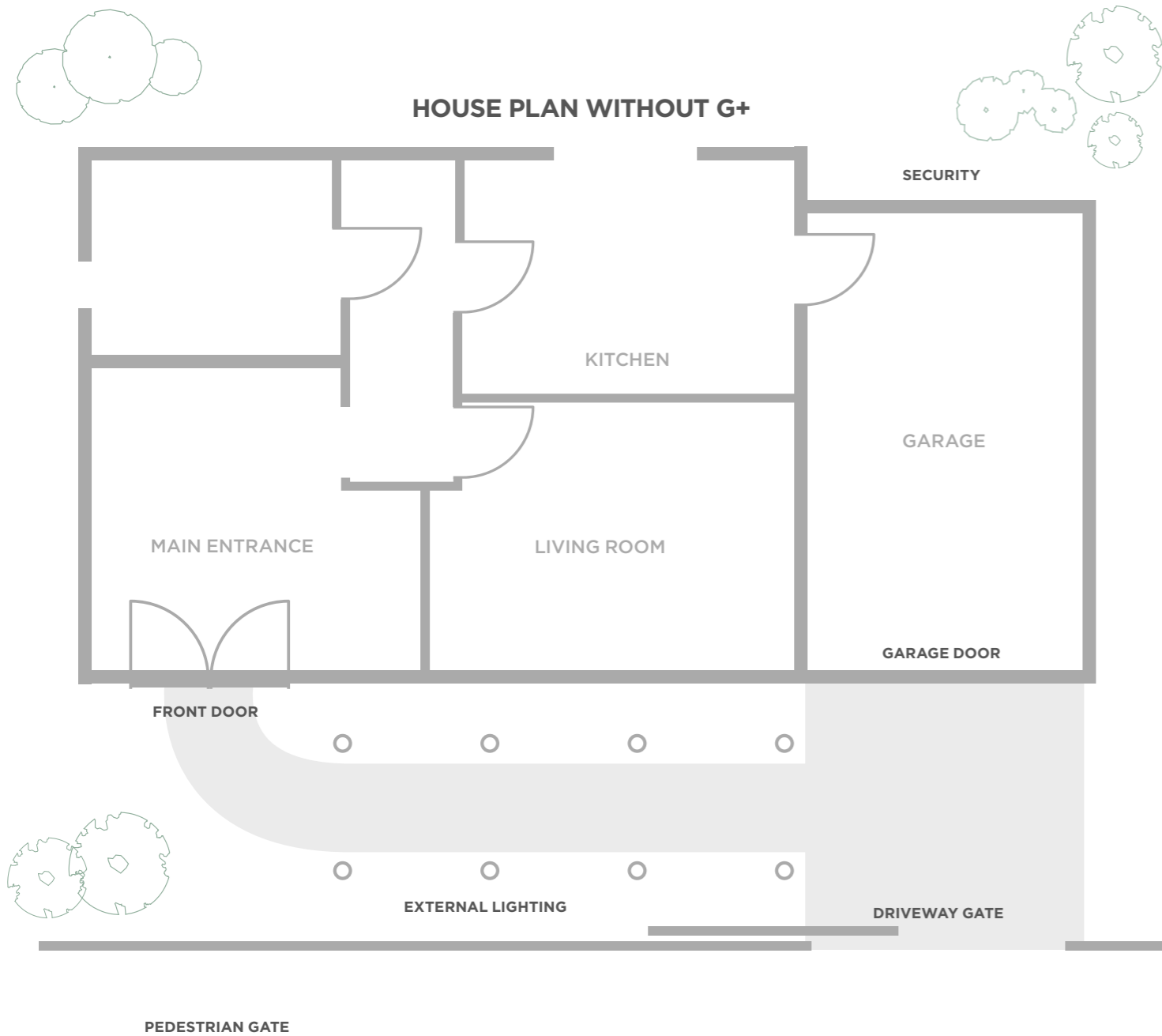

# THE G+ ENABLED HOME

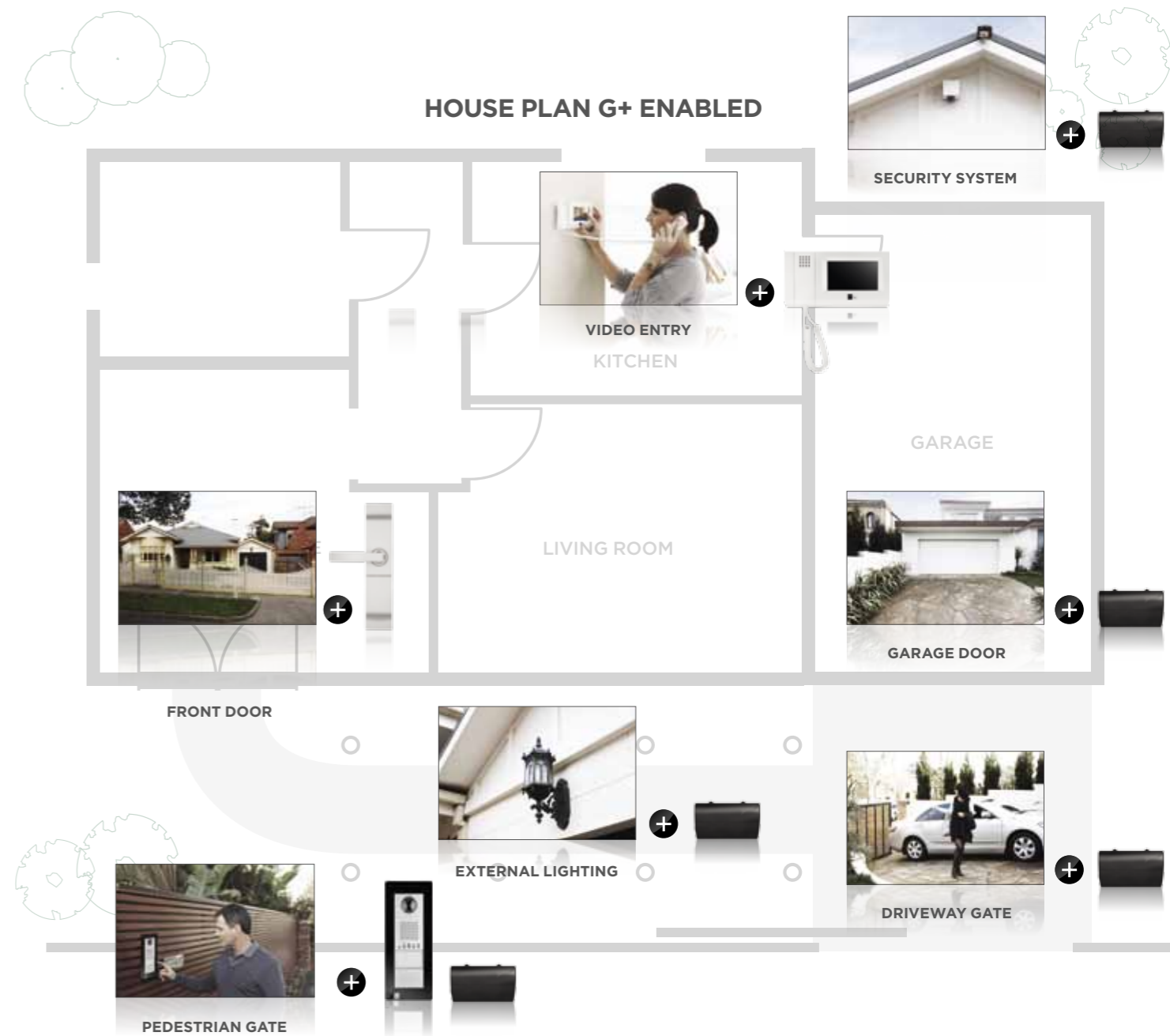

## CREATING YOUR G+ ENABLED HOME

The floor plan above shows the transformation of a typical home into a G+ Enabled Home. The G+ Products show what has been used throughout the home.



1 x ESSENTIALS KIT



5 x SMART BOXES



1 x VIDEO ENTRY KIT

Choose the right solution for your home by viewing our G+ Essentials range on the following pages...



---

# YOUR G+ PRODUCT RANGE

Now that you know how to G+ enable your home, simply order the packaged solutions that meet your requirements.



# PURCHASING G+

## G+ ESSENTIALS

### G+ DOOR HARDWARE AND 2 x G+ KEYS



#### G+ ESSENTIALS KIT ELECTRIC SYSTEM

1 x G+ Lockset  
Choose from a variety of designs and finishes

2 x G+ Keys - Premium  
(All batteries included)



#### G+ ESSENTIALS KIT BATTERY SYSTEM

1 x G+ Lockset  
Choose from a variety of designs and finishes

2 x G+ Keys - Basic  
(All batteries included)

## G+ KEYS



#### G+ KEY PREMIUM

1 x G+ Key  
(Batteries included)



#### G+ KEY BASIC

1 x G+ Key  
(Batteries included)

## G+ SMART BOX



#### G+ SMART BOX

1 x G+ Smart Box  
(Power unit included)



## G+ HOME HUB

#### G+ HOME HUB

1 x G+ Home Hub  
(Power unit included)

## G+ VIDEO ENTRY KIT

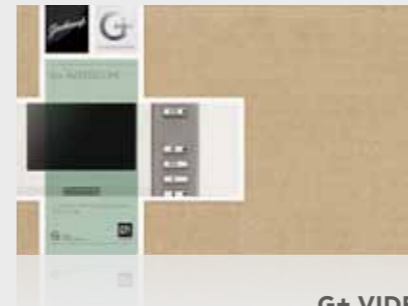

#### G+ VIDEO ENTRY KIT BASIC

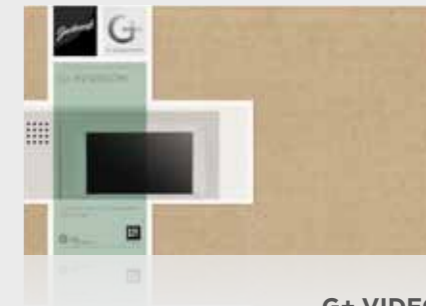

#### G+ VIDEO ENTRY KIT PREMIUM

## G+ MECHANICAL LOCKSETS



#### G+ MECHANICAL LOCKSETS

Choose from a variety of designs and finishes



**Gainsborough Hardware  
Industries Limited**

**Hotline** 13 14 18

**Head Office**

31-33 Alfred Street  
Blackburn, VIC 3130  
PO Box 330, Blackburn VIC

**Telephone** 03 9877 1555

**Fax** 03 9894 1599

**Export Fax** +61 (0)3 9894 1038

**Email** sales@gainsboroughhardware.com.au

**www.gainsboroughhardware.com.au**

**NSW**

Suite 1B,  
126 Taren Point Rd  
Taren Point  
NSW 2229  
**T** 02 9524 4855  
**F** 02 9524 5670

**SA**

31 Lansdowne Tce  
Vale Park  
SA 5081  
**T** 03 9877 1555  
**F** 03 9894 1599

**QLD**

433 Logan Rd  
Stones Corner  
QLD 4120  
**T** 07 3394 8323  
**F** 07 3847 5444

**TAS**

PO Box 330  
Blackburn  
VIC 3130  
**T** 03 9877 1555  
**F** 03 9894 1599

**WA**

12 Juna Drv  
Malaga  
WA 6945  
**T** 08 9209 2511  
**F** 08 9209 2611

**NTH QLD**

Unit 1/17  
Camuglia St  
Mt Louisa  
QLD 4814  
**T** 07 4774 5124  
**F** 07 4774 5292

**VIC**

31-33 Alfred St  
Blackburn  
VIC 3130  
**T** 03 9877 1555  
**F** 03 9894 1599

**NZ**

Unit 5E  
269A Mt Smart Rd  
Penrose  
Auckland  
**T** +64 9 525 6970  
**F** +64 9 525 6982

This document contains general information only and is in no way to be regarded as a complete and comprehensive guide. Gainsborough Hardware Industries Limited ACN 004 792 269 ("Gainsborough Hardware") makes no representation about the content and suitability of this information for any purpose. You should exercise your own independent skill and judgement before you rely on this document and obtain appropriate advice relevant to your particular circumstances. The information is provided "as is" and without express or implied warranty. Gainsborough Hardware disclaims all warranties, including all implied warranties as to merchantability or fitness. In no event shall the Gainsborough Hardware be liable for any direct, special, indirect or consequential damages or any damages whatsoever resulting from loss of income or profits, whether in an action of contract, negligence or other tortious action, arising in connection with the use or performance of the information in this document. The availability of products set out in this document is not guaranteed and Gainsborough Hardware reserves the right to alter, amend or delete any part of this document without prior notice. This disclaimer is subject to any contrary legislative provisions. **TAKE CARE! electricity kills.** Switches, power outlets and other fixed wire products must be installed by a licensed electrical contractor or similarly qualified person.

